

Kann bei Anschlag links und einer Fühler Temperatur von < 23°C auch geschlossen sein/  
Can also be closed in off-position at a sensor temperature of < 23°C

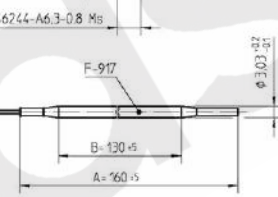
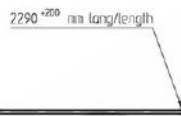
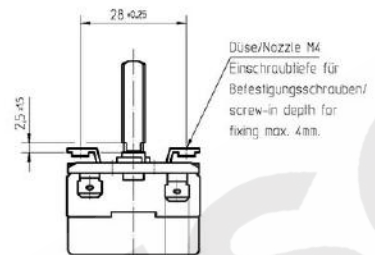
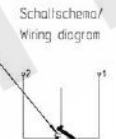

Temperaturregler bei Spindelstellung Anschlag links gezeichnet/  
Thermostat drawn in minimum position

Genehmigte technische Daten/Approved technical data  
55.13000.000, Bl.901

Bemerkungen/Notes:

Normalklima/Standard atmosphere DIN EN 60068-1 (23±2)°C  
Temperaturen sind Mittel-Werte/Temperatures are middle values  
Schalldifferenz/Differential: (7±3)5K  
Im Werknormenbaufl. E.G.O. standard built  
Min. Fühler Temperatur/Min. sensor temperature: -10°C  
Max. Fühler Temperatur/Max. sensor temperature: 330°C  
(aus Sicherheitsgründen/for security reasons)  
Schnappfeder/snap action spring: NiBe  
Max. Gehäuse Temperatur/Max. housing temperature (MDE): 150°C  
Max. Gehäuse Temperatur/Max. housing temperature (UL): 120°C  
Min. Biegeradius Kapillarrohr/ Min. bending radius of capillary tube: 5 mm  
Für Einsatz in Umgebungsbedingungen mit normaler Verunreinigung/  
For application with normal pollution level (Typ 1 B)  
Kunden-Zeichnungs-Nr./Customer drawing-No.: 661 161 162  
auf Gehäuse und Packstück aufgestempelt/  
printed on housing and packing

➔ Korrekturfaktor/correction factor: c = 0,94 [K/K]  
(bez. auf Umgebungstemp./based on ambient temperature)

Temperaturwerte/  
Temperature values

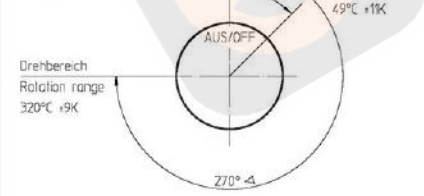

This document is exclusively created for you for the stated purpose. Any kind of duplication, utilization or communication of its content is prohibited, if not expressly consented otherwise. Visitors are committed to pay compensation. Any claims of existing or future property rights remain unaffected.		Blank No. . . . .	EN Mat.No. . . . .	Scale Unit . . . . .					
		Material . . . . .		Scale . . . . .					
		Surface Texture ISO 1302							
		General Tolerances ISO 2768-v							
		CAD . . . . .	Date . . . . .	Name . . . . .					
1	CD0001	2010-12-15	Create	2005-04-13	POSOVSKY				
Cha.	Information No.	Date	Proc.	2005-04-13	POSOVSKY				
FRU	E-04777	2005-04-13	Rel.	2005-04-14	SCHURHAM				
		Drawing No.		Sh.No.	Ver.	Stat.	Sheets	Doc.	ExDoc
		55.13069.020		901	0	F	1	.	.
Origin . . . . .	Real/for 55.13069.020 Bl.-1		Reply . . . . .	Reference RM . . . . .					